

SPORTS LIGHTING BID SPECIFICATION
Lindsay Park Baseball Fields One, Two, and Three

1. TURN KEY SPORTS LIGHTING INSTALLATION

1.1 SCOPE OF WORK

SCOPE OF WORK

1. Furnish and Install Sports Lighting Equipment at Lindsay Park located at 122 Lindsay Park, Bennettsville, SC 29512.
2. Contractor to take down and dispose of the existing wood poles and HID Metal Halide Fixtures and dispose of. One Wood pole that was recently installed to be reused per the Geo Sport Lighting Photometric designs. Contractor to install new Geo Sport Lighting LED Sports Lighting Fixtures and Class Three Wood Poles with new Mounting Crossarms to meet Recreational Play Lighting for 30 Maintained Foot-Candles Infield and 20 Foot-Candles Outfield.
3. Sports Lighting Pole Counts, Pole Heights, and (82) LED Sports Lighting Fixture Counts per the Geo Sport Lighting Photometric Design dated 01-24-2023 for Recreational Play Lighting. The local Geo Sport Lighting representative is Mike Torrence and the phone number is 704-953-0680. Email address is mtorrence@tsportslight.com
4. Tournament Play lighting for 50 foot-candles infield and 30 foot-candles is the Add Alternate price on bid form.
5. Locate any underground lines before digging. Contractor required to call in locator.
6. The LED Sports Lighting basis of design is Geo Sport Lighting LED Fixtures.
7. Base Bid Warranty is 10 years parts and one year labor.
8. Any underground irrigation lines currently installed at the field to be marked by owner.
9. Any fencing damages or removal to be replaced by the contractor.
10. Trenching will be allowed for this scope of work around the outside perimeter of the fields Contractor required to tamp, seed, and straw.
11. Contractor responsible to remove spoils from the jobsite.
12. Provide and install a new galvanized structure with main distribution panel with a Key Switch Lighting Contactor Cabinet. Each field shall be turned on with a key switch.
13. It will be the responsibility of the bidding electrical contractor to stake and survey pole locations. Owner to verify pole locations prior to boring of the holes.

14. Engineered Electrical Drawings Stamped by a South Carolina PE to be provided by bidding electrical contractors (If Required for the project).
15. Electrical equipment should be specified as ITE Siemens, Square D, GE, or Cutler Hammer or approved equal.
16. The existing transformer to be reused for the project. If it is determined that power is to be upgrade then costs for the transformer to be provided direct to Owner by the power company. If the power company requires the transformer pad to be provided by the electrical contractor then cost to be included by the electrical contractor for this.
17. Provide and install all new underground copper wiring in conduit to each pole.
18. All permits will be obtained by the contractor. Any charges for permits responsibility of contractor.
19. All taxes to be included in the contractor's proposal.
20. Encounter of any embedded rock removal or unsuitable soil to be billed time and material. It will be the responsibility of the bidding electrical contractor to notify the owner and agree on a price before performing work.
21. It is encouraged for the bidding contractors to make a site visit but not mandatory.
22. Contact for this project will be Doug Carabo. Any scope of work bidding questions should be emailed to dacarabo@marlborocounty.sc.gov. All questions will be addressed and sent to all bidding contractors.
23. A formal light test shall be conducted in the presence of the owner, contractor, and lighting representative. Actual readings must meet the required levels and uniformities set forth in written specifications.
24. Lighting systems not meeting performance criteria for this project shall be upgraded at the contractor's expense until the owner is satisfied that all lighting, structural, and electrical components meet the specifications herein.
25. Contractor to provide all insurance requirements prior to contract award required by Owner.
26. The awarded contract bidder will provide all materials and labor according to the scope of work above.
27. Sales Tax on Materials to Be Included with Total Bid Cost.

Failure to provide any of the above-described documentation will be grounds for proposal rejection.

Pre-bid Meeting:	Wednesday February 21, 2023, 12:00 PM
Mandatory	205 E Market St
	Bennettsville, SC 29512
Public Bids Due:	Friday, March 3, 2023, 12:00 PM
Opening:	Friday, March 3, 2023, 12:00 PM
Location:	William P. Wallace, Sr. Administration Building
	205 East Market St, Bennettsville SC, 29512
	All bids will be opened and read aloud in public.

Lindsay Park Baseball Fields One, Two and Three

BASE BID - As shown in scope of work above: \$ _____

Base Bid price includes all labor, materials, permits taxes, and anything else to complete project

ADD ALTERNATE ONE TO BASE BID: Add \$ _____ to the base bid lump sum for the sports lighting to be tournament play lighting for 50 Foot-Candles Infield and 30 Foot-Candles Outfield.

COMPANY NAME: _____ DATE: _____

COMPANY ADDRESS: _____

CONTACT NAME: _____

SC ELECTRICAL LICENSE NUMBER: _____

CONTACT SIGNATURE: _____

COMPANY FAX: _____ COMPANY PHONE: _____

EMAIL ADDRESS: _____

Insuring that bids are received by Owner received on time is the sole responsibility of the bidding contractor. Owner takes no responsibility for the lost or late submissions. You can submit a quote on your company quote form/letterhead if you are not using the attached bid form. Be sure to include the pertinent information.

All prices and notations shall be printed in ink or typewritten. Errors shall be crossed out and corrections entered and initialed by the person signing the bid. Erasures or use of typewriter correction media may be cause for rejection of the bid. No bid shall be altered or amended after the specified time for opening.

Owner reserves the right to reject portions of a bid, as well as any and all bids in their entirety and to waive minor irregularities in the bid that, in the opinion of the foundation, do not affect the overall validity of the bid.

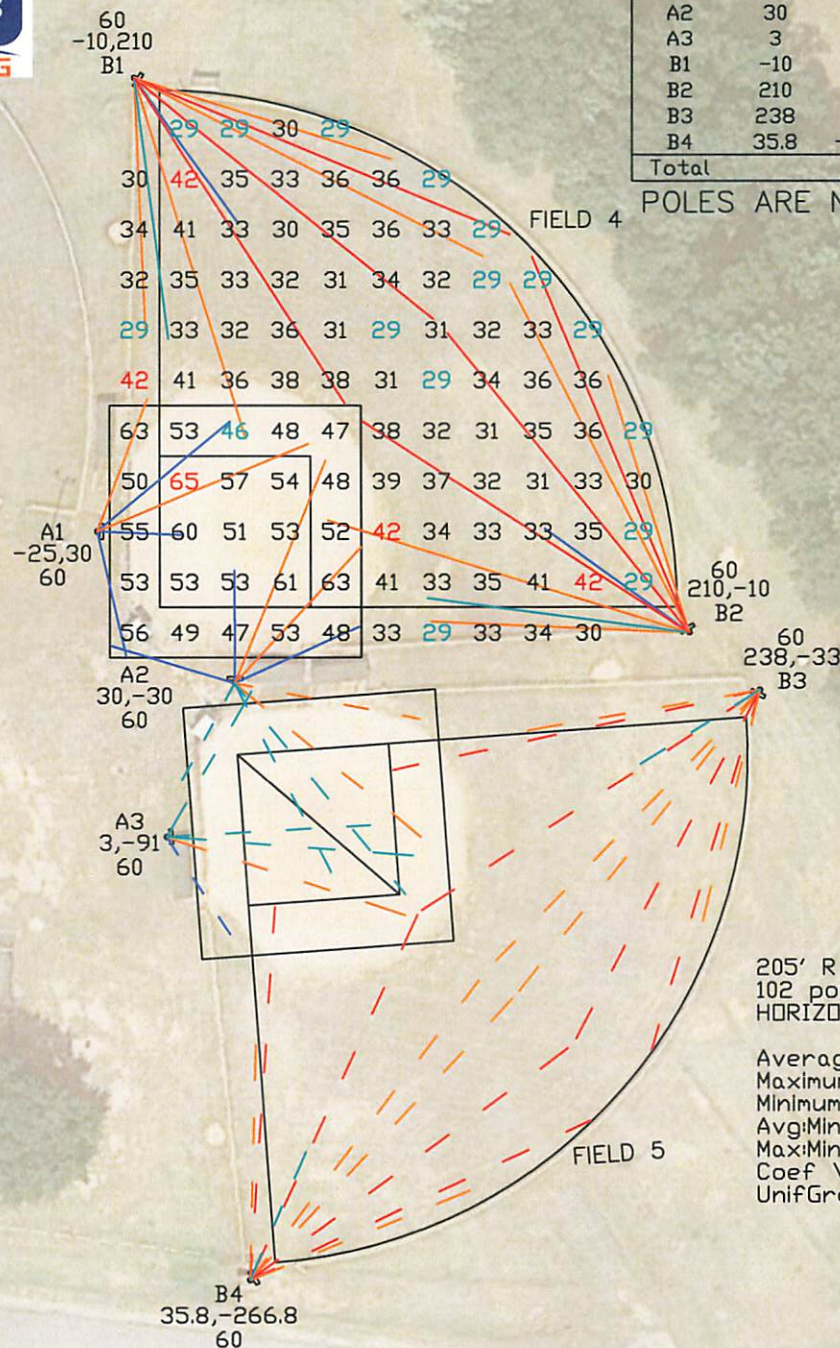

Pole	x-loc	y-loc	height	N-15	M-20	W-40	EW-60	Total	kw
A1	-25	30	60ft		2	3		5	3.2
A2	30	-30	60ft		4	3	3	5-5	6.2
A3	3	-91	60ft		1	1	3	5	3.1
B1	-10	210	60ft	3	4	1	1	9	5.6
B2	210	-10	60ft	3	4	1	1	9	5.6
B3	238	-33	60ft	4	4		1	9	5.6
B4	35.8	-266.8	60ft	4	4		1	9	5.6
Total				14	23	9	10	56	34.8

POLES ARE NEW

EW-60
GEOSPORT CLIR SV 630W
Light Loss Factor = 0.950
Watts per luminaire = 612
Number luminaires used = 10
kw these luminaires = 6.1

W-40
GEOSPORT CLIR SV 630W
Light Loss Factor = 0.950
Watts per luminaire = 632
Number luminaires used = 9
kw these luminaires = 5.7

N-15
GEOSPORT CLIR SV 630W
Light Loss Factor = 0.950
Watts per luminaire = 611
Number luminaires used = 14
kw these luminaires = 8.6

M-20
GEOSPORT CLIR SV 630W
Light Loss Factor = 0.950
Watts per luminaire = 628
Number luminaires used = 23
kw these luminaires = 14.4

205' R FIELD 4
102 points (25 infield, 77 outfield) at z=3, sp 20ft by 20ft
HORIZONTAL FOOTCANDLES

	Outfield	Infield
Average	34	54
Maximum	42	65
Minimum	29	46
Avg:Min	1.16	1.16
Max:Min	1.45	1.41
Coef Var	0.11	0.10
UnifGrad	1.45	1.31



LINDSAY PARK-BENNETTSVILLE-SC-FIELD 4-D1

Revision 1	02/06/23	Drawing 1 of 2	877-663-5968 WWW.GEOSPORTLIGHTING.COM
------------	----------	----------------	--



Pole	x-loc	y-loc	height	N-15	M-20	W-40	EW-60	Total	kw
A1	-25	30	60ft		2	3		5	3.2
A2	30	-30	60ft		4	3	3	5-5	6.2
A3	3	-91	60ft		1	1	3	5	3.1
B1	-10	210	60ft	3	4	1	1	9	5.6
B2	210	-10	60ft	3	4	1	1	9	5.6
B3	238	-33	60ft	4	4		1	9	5.6
B4	35.8	-266.8	60ft	4	4		1	9	5.6
Total				14	23	9	10	56	34.8

POLES ARE NEW

EW-60
GEOSPORT CLIR SV 630W
Light Loss Factor = 0.950
Watts per luminaire = 612
Number luminaires used = 10
kw these luminaires = 6.1

W-40
GEOSPORT CLIR SV 630W
Light Loss Factor = 0.950
Watts per luminaire = 632
Number luminaires used = 9
kw these luminaires = 5.7

N-15
GEOSPORT CLIR SV 630W
Light Loss Factor = 0.950
Watts per luminaire = 611
Number luminaires used = 14
kw these luminaires = 8.6

M-20
GEOSPORT CLIR SV 630W
Light Loss Factor = 0.950
Watts per luminaire = 628
Number luminaires used = 23
kw these luminaires = 14.4

202' FIELD 5
98 points (25 infield, 73 outfield) at z=3, sp 20ft by 20ft
HORIZONTAL FOOTCANDLES

	Outfield	Infield
Average	32	52
Maximum	41	62
Minimum	28	45
AvgMin	1.15	1.15
MaxiMin	1.46	1.38
Coef Var	0.12	0.12
UnifGrad	1.32	1.33



LINDSAY PARK-BENNETTSVILLE-SC-FIELD 4-D2

Revision 1	02/06/23	Drawing 2 of 2	877-663-5968 WWW.GEOSPORTLIGHTING.COM
------------	----------	----------------	--

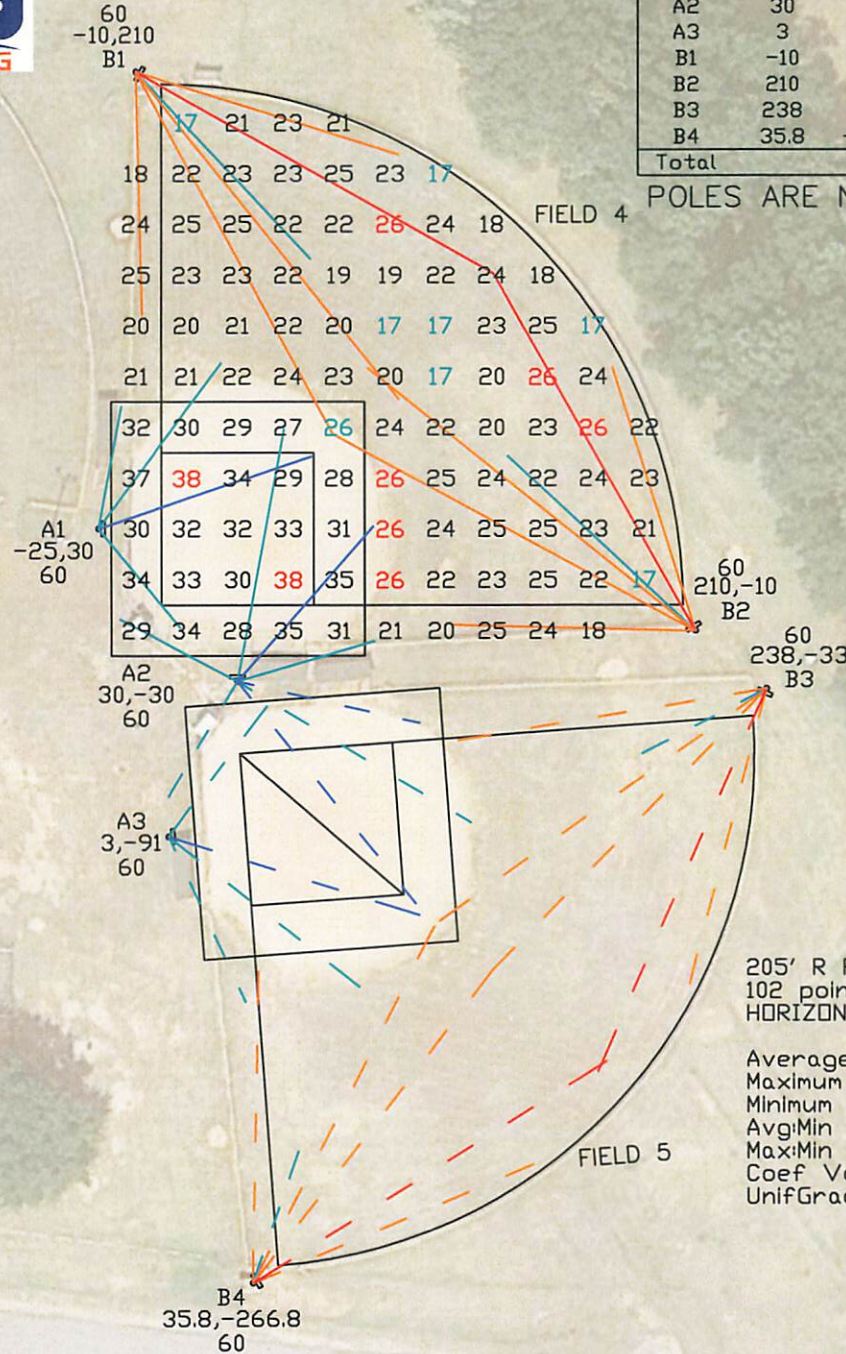

Pole	x-loc	y-loc	height	N-15	M-20	W-40	EW-60	Total	kw
A1	-25	30	60ft			1	3	4	2.5
A2	30	-30	60ft			3	5	4-4	5.0
A3	3	-91	60ft			1	3	4	2.5
B1	-10	210	60ft	1	4		1	6	3.7
B2	210	-10	60ft	1	4		1	6	3.7
B3	238	-33	60ft	1	4		1	6	3.7
B4	35.8	-266.8	60ft	1	4		1	6	3.7
Total				4	16	5	15	40	24.8

POLES ARE NEW

N-15
GEOSPORT CLIR SV 630W
Light Loss Factor = 0.950
Watts per luminaire = 611
Number luminaires used = 4
kw these luminaires = 2.4

EW-60
GEOSPORT CLIR SV 630W
Light Loss Factor = 0.950
Watts per luminaire = 612
Number luminaires used = 15
kw these luminaires = 9.2

M-20
GEOSPORT CLIR SV 630W
Light Loss Factor = 0.950
Watts per luminaire = 628
Number luminaires used = 16
kw these luminaires = 10.0

W-40
GEOSPORT CLIR SV 630W
Light Loss Factor = 0.950
Watts per luminaire = 632
Number luminaires used = 5
kw these luminaires = 3.2

205' R FIELD 4
102 points (25 infield, 77 outfield) at z=3, sp 20ft by 20ft
HORIZONTAL FOOTCANDLES

	Outfield	Infield
Average	22	32
Maximum	26	38
Minimum	17	26
Avg:Min	1.30	1.22
Max:Min	1.53	1.46
Coef Var	0.12	0.10
UnifGrad	1.47	1.27



LINDSAY PARK-BENNETTSTVILLE-SC-FIELD 5-D1



Pole	x-loc	y-loc	height	N-15	M-20	W-40	EW-60	Total	kw
A1	-25	30	60ft			1	3	4	2.5
A2	30	-30	60ft			3	5	4-4	5.0
A3	3	-91	60ft			1	3	4	2.5
B1	-10	210	60ft	1	4		1	6	3.7
B2	210	-10	60ft	1	4		1	6	3.7
B3	238	-33	60ft	1	4		1	6	3.7
B4	35.8	-266.8	60ft	1	4		1	6	3.7
Total				4	16	5	15	40	24.8

POLES ARE NEW

N-15
GEOSPORT CLIR SV 630W
Light Loss Factor = 0.950
Watts per luminaire = 611
Number luminaires used = 4
kw these luminaires = 2.4

EW-60
GEOSPORT CLIR SV 630W
Light Loss Factor = 0.950
Watts per luminaire = 612
Number luminaires used = 15
kw these luminaires = 9.2

M-20
GEOSPORT CLIR SV 630W
Light Loss Factor = 0.950
Watts per luminaire = 628
Number luminaires used = 16
kw these luminaires = 10.0

W-40
GEOSPORT CLIR SV 630W
Light Loss Factor = 0.950
Watts per luminaire = 632
Number luminaires used = 5
kw these luminaires = 3.2

202' FIELD 5
98 points (25 Infield, 73 outfield) at z=3, sp 20ft by 20ft
HORIZONTAL FOOTCANDLES

	Outfield	Infield
Average	22	32
Maximum	26	37
Minimum	18	25
Avg/Min	1.23	1.26
Max/Min	1.44	1.48
Coef Var	0.10	0.13
UnifGrad	1.33	1.38



LINDSAY PARK-BENNETTSTVILLE-SC-FIELD 5-D2



Pole	x-loc	y-loc	height	N-15	M-20	W-40	EW-60	Total	kw
A1	-105	24	60ft		3	3		6	3.8
A2	-28.6	88.1	60ft		3	3		6	3.8
A3	-30	30	60ft		3	2		5	3.1
A4	30	-30	60ft		3	2		5	3.1
A5	125	-127	60ft		3	1	1	5	3.1
A6	95.5	-175.1	60ft		3	1	1	5	3.1
B1	-257	52	60ft	2	3	1	2	8	5.0
B2	-29.8	242.7	60ft	2	3	1	2	8	5.0
B3	-25	190	60ft	1	7		2	10	6.2
B4	190	-25	60ft	1	7		2	10	6.2
B5	320	-182	60ft	1	4	2	2	9	5.6
B6	233.1	-323.9	60ft	1	4	2	2	9	5.6
C1	-325	176	60ft		6	1	1	8	5.0
C2	-140.1	331.2	60ft		6	1	1	8	5.0
C3	100	275	60ft	3	2	2		7	4.4
C4	264	96	60ft	2	3		2	7	4.3
Total				13	63	22	18	116	72.4

WOODEN POLES PROVIDED BY OWNER

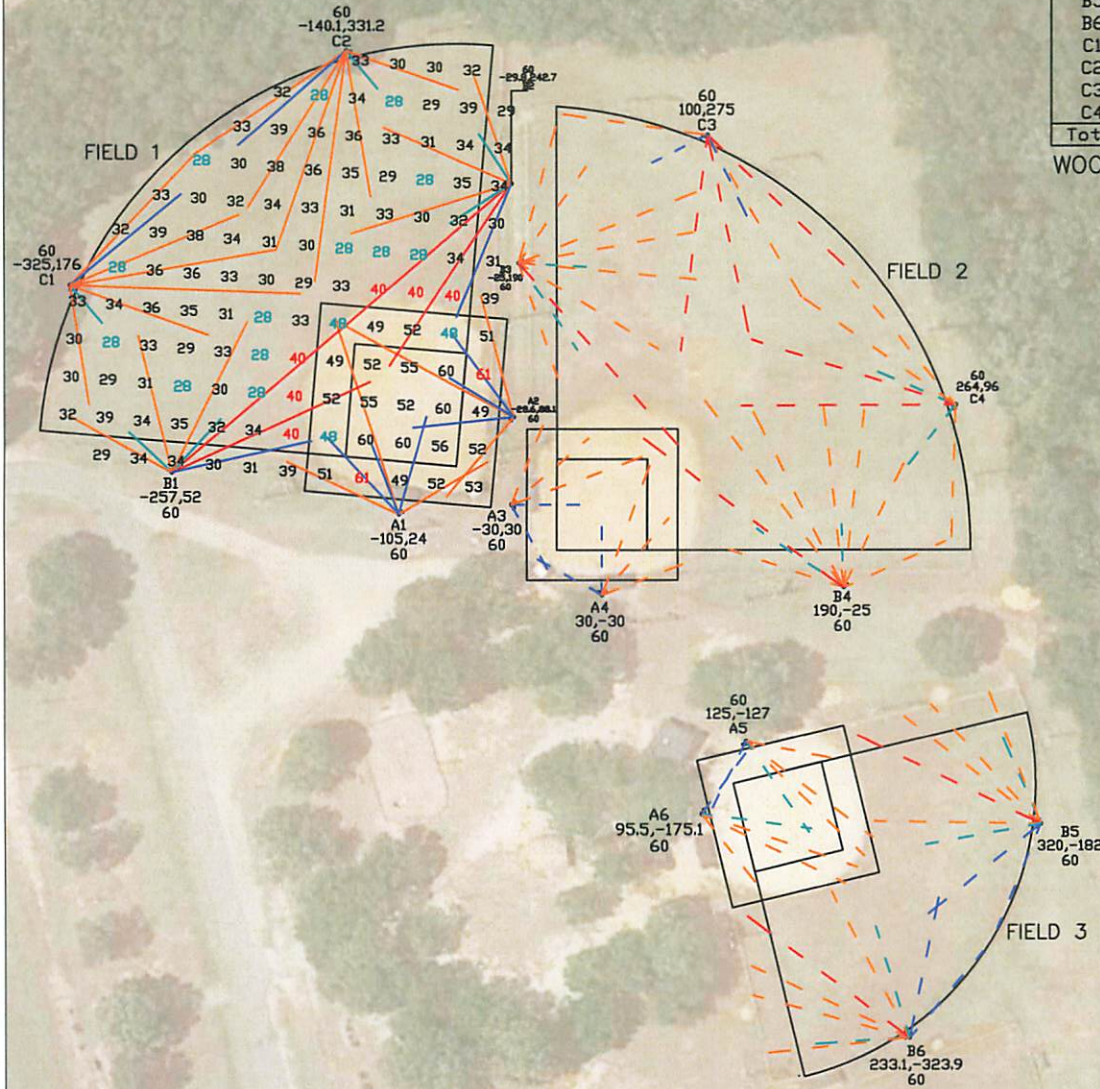

N-15
GEOSPORT CLIR SV 630W
Light Loss Factor = 0.950
Watts per luminaire = 611
Number luminaires used = 13
kw these luminaires = 7.9

EW-60
GEOSPORT CLIR SV 630W
Light Loss Factor = 0.950
Watts per luminaire = 612
Number luminaires used = 18
kw these luminaires = 11.0

W-40
GEOSPORT CLIR SV 630W
Light Loss Factor = 0.950
Watts per luminaire = 632
Number luminaires used = 22
kw these luminaires = 13.9

M-20
GEOSPORT CLIR SV 630W
Light Loss Factor = 0.950
Watts per luminaire = 628
Number luminaires used = 63
kw these luminaires = 39.6

280' R FIELD 1
119 points (25 Infield, 94 outfield) at z=3, sp 25ft by 25ft
HORIZONTAL FOOTCANDLES

	Outfield	Infield
Average	33	53
Maximum	40	61
Minimum	28	48
Avg/Min	1.17	1.11
Max/Min	1.43	1.27
Coef Var	0.11	0.08
UnifGrad	1.43	1.25



LINDSAY PARK-BENNETTSVILLE-SC-D1

Revision 1 01/24/23 Drawing 1 of 3 877-663-5968
WWW.GEOSPORTLIGHTING.COM



Pole	x-loc	y-loc	height	N-15	M-20	W-40	EW-60	Total	kw
A1	-105	24	60ft		3	3		6	3.8
A2	-28.6	88.1	60ft		3	3		6	3.8
A3	-30	30	60ft		3	2		5	3.1
A4	30	-30	60ft		3	2		5	3.1
A5	125	-127	60ft		3	1	1	5	3.1
A6	95.5	-175.1	60ft		3	1	1	5	3.1
B1	-257	52	60ft	2	3	1	2	8	5.0
B2	-29.8	242.7	60ft	2	3	1	2	8	5.0
B3	-25	190	60ft	1	7		2	10	6.2
B4	190	-25	60ft	1	7		2	10	6.2
B5	320	-182	60ft	1	4	2	2	9	5.6
B6	233.1	-323.9	60ft	1	4	2	2	9	5.6
C1	-325	176	60ft		6	1	1	8	5.0
C2	-140.1	331.2	60ft		6	1	1	8	5.0
C3	100	275	60ft	3	2	2		7	4.4
C4	264	96	60ft	2	3		2	7	4.3
Total				13	63	22	18	116	72.4

WOODEN POLES PROVIDED BY OWNER

N-15
GEOSPORT CLIR SV 630W
Light Loss Factor = 0.950
Watts per luminaire = 611
Number luminaires used = 13
kw these luminaires = 7.9

EW-60
GEOSPORT CLIR SV 630W
Light Loss Factor = 0.950
Watts per luminaire = 612
Number luminaires used = 18
kw these luminaires = 11.0

W-40
GEOSPORT CLIR SV 630W
Light Loss Factor = 0.950
Watts per luminaire = 632
Number luminaires used = 22
kw these luminaires = 13.9

M-20
GEOSPORT CLIR SV 630W
Light Loss Factor = 0.950
Watts per luminaire = 628
Number luminaires used = 39.6

294'x 280'x 274' FIELD 2
184 points (25 infield, 159 outfield) at z=3, sp 20ft by 20ft
HORIZONTAL FOOTCANDLES

	Outfield	Infield
Average	34	55
Maximum	41	62
Minimum	28	48
Avg:Min	1.20	1.14
Max:Min	1.46	1.29
Coef Var	0.11	0.09
UnifGrad	1.41	1.29



LINDSAY PARK-BENNETTSVILLE-SC-D2

Revision 1	01/24/23	Drawing 2 of 3	877-663-5968 WWW.GEOSPORTLIGHTING.COM
------------	----------	----------------	--



Pole	x-loc	y-loc	height	N-15	M-20	W-40	EW-60	Total	kw
A1	-105	24	60ft		3	3		6	3.8
A2	-28.6	88.1	60ft		3	3		6	3.8
A3	-30	30	60ft		3	2		5	3.1
A4	30	-30	60ft		3	2		5	3.1
A5	125	-127	60ft		3	1	1	5	3.1
A6	95.5	-175.1	60ft		3	1	1	5	3.1
B1	-257	52	60ft	2	3	1	2	8	5.0
B2	-29.8	242.7	60ft	2	3	1	2	8	5.0
B3	-25	190	60ft	1	7		2	10	6.2
B4	190	-25	60ft	1	7		2	10	6.2
B5	320	-182	60ft	1	4	2	2	9	5.6
B6	233.1	-323.9	60ft	1	4	2	2	9	5.6
C1	-325	176	60ft		6	1	1	8	5.0
C2	-140.1	331.2	60ft		6	1	1	8	5.0
C3	100	275	60ft	3	2	2		7	4.4
C4	264	96	60ft	2	3		2	7	4.3
Total				13	63	22	18	116	72.4

WOODEN POLES PROVIDED BY OWNER

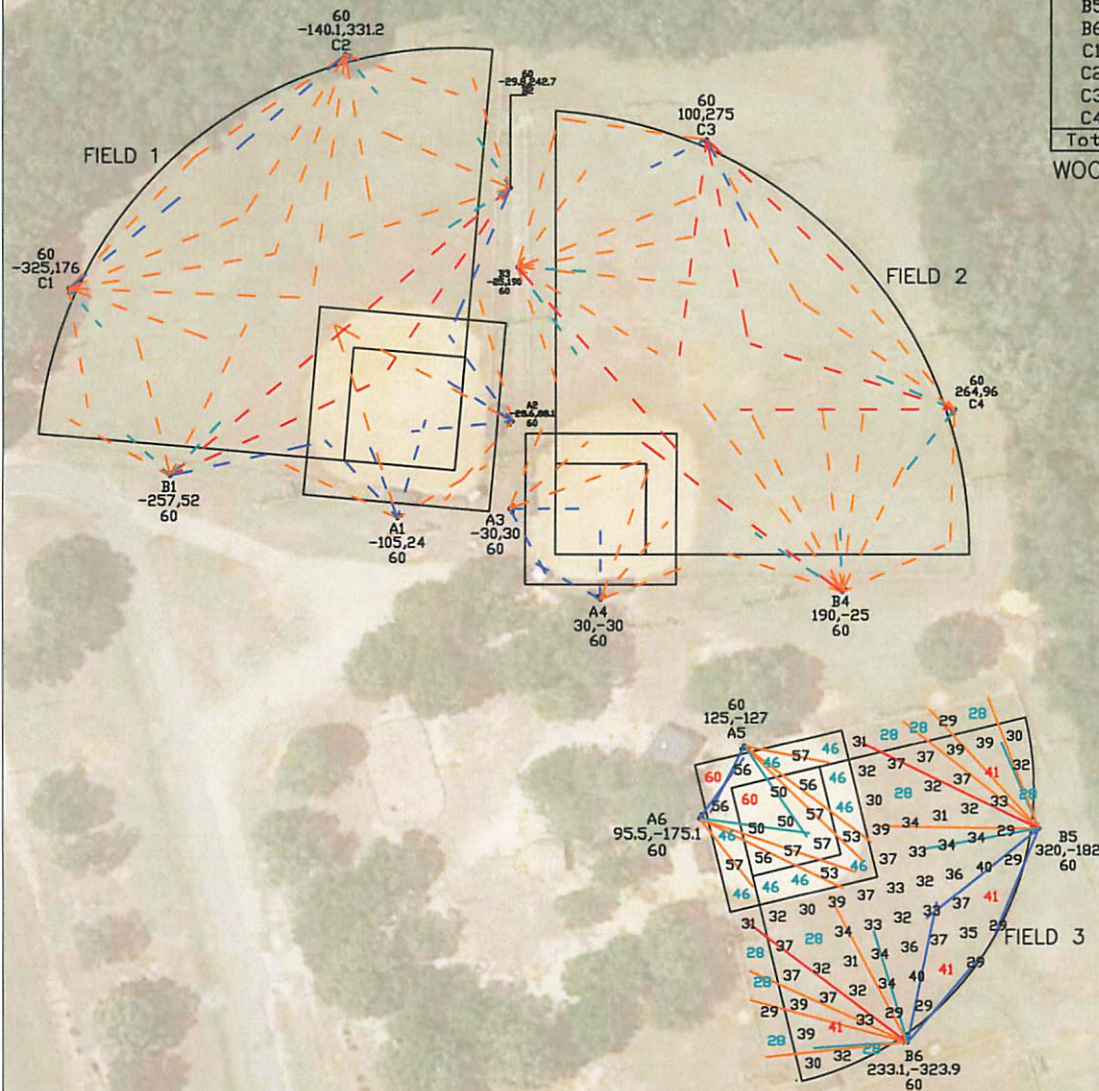

N-15
GEOSPORT CLIR SV 630W
Light Loss Factor = 0.950
Watts per luminaire = 611
Number luminaires used = 13
kw these luminaires = 7.9

EW-60
GEOSPORT CLIR SV 630W
Light Loss Factor = 0.950
Watts per luminaire = 612
Number luminaires used = 18
kw these luminaires = 11.0

W-40
GEOSPORT CLIR SV 630W
Light Loss Factor = 0.950
Watts per luminaire = 632
Number luminaires used = 22
kw these luminaires = 13.9

M-20
GEOSPORT CLIR SV 630W
Light Loss Factor = 0.950
Watts per luminaire = 628
Number luminaires used = 63
kw these luminaires = 39.6

200' R FIELD 3
98 points (25 infield, 73 outfield) at z=3, sp 20ft by 20ft
HORIZONTAL FOOTCANDLES

	Outfield	Infield
Average	33	52
Maximum	41	60
Minimum	28	46
AvgMin	1.19	1.13
MaxMin	1.46	1.30
Coef Var	0.12	0.10
UnifGrad	1.41	1.24



LINDSAY PARK-BENNETTSVILLE-SC-D3

Revision 1 01/24/23 Drawing 3 of 3 877-663-5968
WWW.GEOSPORTLIGHTING.COM



Pole	x-loc	y-loc	height	M-20	W-40	EW-60	Total	kw
A1	-105	24	60ft	1	3		4	2.5
A2	-28.6	88.1	60ft	1	3		4	2.5
A3	-30	30	60ft		2	2	4	2.5
A4	30	-30	60ft		2	2	4	2.5
A5	125	-127	60ft	2	1	1	4	2.5
A6	95.5	-175.1	60ft	2	1	1	4	2.5
B1	-257	52	60ft	2	2	2	6	3.7
B2	-29.8	242.7	60ft	2	2	2	6	3.7
B3	-25	190	60ft	2	2	3	7	4.4
B4	190	-25	60ft	1	3	3	7	4.4
B5	320	-182	60ft	3		3	6	3.7
B6	233.1	-323.9	60ft	3		3	6	3.7
C1	-325	176	60ft	3		2	5	3.1
C2	-140.1	331.2	60ft	3		2	5	3.1
C3	100	275	60ft	3		1	5	3.1
C4	264	96	60ft	3	1	1	5	3.1
Total				31	23	28	82	51.1

WOODEN POLES PROVIDED BY OWNER

EW-60
GEOSPORT CLIR SV 630W
Light Loss Factor = 0.950
Watts per luminaire = 612
Number luminaires used = 28
kw these luminaires = 17.1

W-40
GEOSPORT CLIR SV 630W
Light Loss Factor = 0.950
Watts per luminaire = 632
Number luminaires used = 23
kw these luminaires = 14.5

M-20
GEOSPORT CLIR SV 630W
Light Loss Factor = 0.950
Watts per luminaire = 628
Number luminaires used = 31
kw these luminaires = 19.5

280' R FIELD 1
119 points (25 infield, 94 outfield) at z=3, sp 25ft by 25ft
HORIZONTAL FOOTCANDLES

	Outfield	Infield
Average	21	32
Maximum	26	41
Minimum	18	26
Avg/Min	1.18	1.25
Max/Min	1.44	1.58
Coef Var	0.14	0.16
UnifGrad	1.44	1.38



LINDSAY PARK-BENNETTSVILLE-SC-D1

Revision 1 01/24/23 Drawing 1 of 3 877-663-5968
WWW.GEOSPORTLIGHTING.COM



Pole	x-loc	y-loc	height	M-20	W-40	EW-60	Total	kw
A1	-105	24	60ft	1	3		4	2.5
A2	-28.6	88.1	60ft	1	3		4	2.5
A3	-30	30	60ft		2	2	4	2.5
A4	30	-30	60ft		2	2	4	2.5
A5	125	-127	60ft	2	1	1	4	2.5
A6	95.5	-175.1	60ft	2	1	1	4	2.5
B1	-257	52	60ft	2	2	2	6	3.7
B2	-29.8	242.7	60ft	2	2	2	6	3.7
B3	-25	190	60ft	2	2	3	7	4.4
B4	190	-25	60ft	1	3	3	7	4.4
B5	320	-182	60ft	3		3	6	3.7
B6	233.1	-323.9	60ft	3	3	3	6	3.7
C1	-325	176	60ft	3		2	5	3.1
C2	-140.1	331.2	60ft	3		2	5	3.1
C3	100	275	60ft	3	1	1	5	3.1
C4	264	96	60ft	3	1	1	5	3.1
Total				31	23	28	82	51.1

WOODEN POLES PROVIDED BY OWNER

EW-60
GEOSPORT CLIR SV 630W
Light Loss Factor = 0.950
Watts per luminaire = 612
Number luminaires used = 28
kw these luminaires = 17.1

W-40
GEOSPORT CLIR SV 630W
Light Loss Factor = 0.950
Watts per luminaire = 632
Number luminaires used = 23
kw these luminaires = 14.5

M-20
GEOSPORT CLIR SV 630W
Light Loss Factor = 0.950
Watts per luminaire = 628
Number luminaires used = 31
kw these luminaires = 19.5

294'x 280'x 274' FIELD 2
184 points (25 infield, 159 outfield) at z=3, sp 20ft by 20ft
HORIZONTAL FOOTCANDLES

	Outfield	Infield
Average	22	31
Maximum	26	35
Minimum	17	25
AvgMin	1.29	1.24
MaxMin	1.53	1.40
Coef Var	0.13	0.10
UnifGrad	1.53	1.28



LINDSAY PARK-BENNETTSVILLE-SC-D2

Revision 1	01/24/23	Drawing 2 of 3	877-663-5968 WWW.GEOSPORTLIGHTING.COM
------------	----------	----------------	--

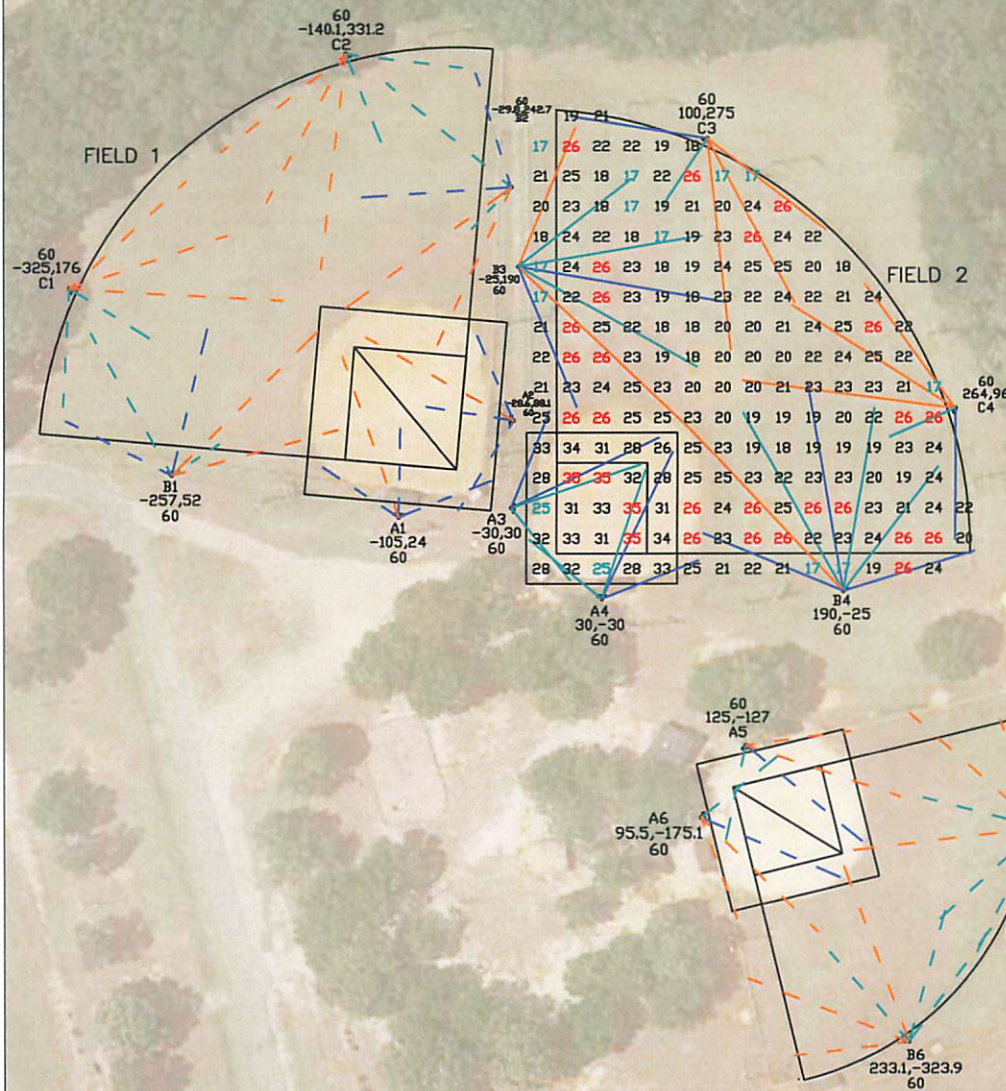



Pole	x-loc	y-loc	height	M-20	W-40	EW-60	Total	kw
A1	-105	24	60ft	1	3		4	2.5
A2	-28.6	88.1	60ft	1	3		4	2.5
A3	-30	30	60ft		2	2	4	2.5
A4	30	-30	60ft		2	2	4	2.5
A5	125	-127	60ft	2	1	1	4	2.5
A6	95.5	-175.1	60ft	2	1	1	4	2.5
B1	-257	52	60ft	2	2	2	6	3.7
B2	-29.8	242.7	60ft	2	2	2	6	3.7
B3	-25	190	60ft	2	2	3	7	4.4
B4	190	-25	60ft	1	3	3	7	4.4
B5	320	-182	60ft	3		3	6	3.7
B6	233.1	-323.9	60ft	3		3	6	3.7
C1	-325	176	60ft	3		2	5	3.1
C2	-140.1	331.2	60ft	3		2	5	3.1
C3	100	275	60ft	3	1	1	5	3.1
C4	264	96	60ft	3	1	1	5	3.1
Total				31	23	28	82	51.1

WOODEN POLES PROVIDED BY OWNER

EW-60
GEOSPORT CLIR SV 630W
Light Loss Factor = 0.950
Watts per luminaire = 612
Number luminaires used = 28
kw these luminaires = 17.1

W-40
GEOSPORT CLIR SV 630W
Light Loss Factor = 0.950
Watts per luminaire = 632
Number luminaires used = 23
kw these luminaires = 14.5

M-20
GEOSPORT CLIR SV 630W
Light Loss Factor = 0.950
Watts per luminaire = 628
Number luminaires used = 31
kw these luminaires = 19.5

200' R FIELD 3
98 points (25 infield, 73 outfield) at z=3, sp 20ft by 20ft
HORIZONTAL FOOTCANDLES

	Outfield	Infield
Average	24	31
Maximum	29	39
Minimum	17	23
Avg/Min	1.41	1.34
Max/Min	1.71	1.70
Coef Var	0.17	0.13
UnifGrad	1.65	1.35



LINDSAY PARK-BENNETTSVILLE-SC-D3

Revision 1	01/24/23	Drawing 3 of 3	877-663-5968 WWW.GEOSPORTLIGHTING.COM
------------	----------	----------------	--